

## Solar Battery 2V 1500Ah Sunipod HCAP-2V 1500Ah

Hi-performance batteries designed to meet the demands of solar power generation applications

### HIGHLIGHTS

- Flame retardant cell container and cover material.
- Proprietary process technology ideal for tropical conditions.
- Robust and aesthetically attractive modular design.
- Leak resistant double seal terminal design.
- High performance operation with no maintenance (doesn't require routine water additions or specific gravity checks).
- Efficient Vent Valve Assembly.
- Reliable performance under float and cyclic usage.
- Balanced active material design.
- Excellent charge acceptance.
- Good deep discharge recovery.
- Uniformly useful capacity during its expected service life.
- Long Cycle Life of 1200 cycles at 50% DOD.
- **Long Float Life at 27°C.**
- Usage of highest purity material results Low self discharge Long Shelf life.
- Heavy-duty plates.
- High conductivity lead coated copper connectors.
- Better usage of foot print area due to stackable modular design.



### APPLICATIONS:

- Diesel Generator Alternative Using Solar Power Plants
- Lower Your Electric Bill Using Solar Power Stations

### SPECIFICATIONS

|                        |              |        |
|------------------------|--------------|--------|
| Nominal Voltage        | 2V           |        |
| Capacity (10 hr, 25°C) | 1500Ah       |        |
| Dimension              | Length       | 401 mm |
|                        | Width        | 351 mm |
|                        | Height       | 342 mm |
|                        | Total Height | 369 mm |
| Approx. Weight         | 101 Kg       |        |

### CHARACTERISTICS

|                 |                             |        |
|-----------------|-----------------------------|--------|
| Capacity (25°C) | 10 hour rate                | 1500Ah |
|                 | 5 hour rate                 | 1200Ah |
|                 | 1 hour rate                 | 900Ah  |
|                 | 1.5 hour discharge to 1.75V | 600A   |

### CHARACTERISTICS cont.

|   |                |                         |
|---|----------------|-------------------------|
| Capacity affected by temperature (10 hr)  | 40°C           | 102%                    |
|   | 25°C           | 100%                    |
|   | 0°C            | 85%                     |
|   | -15°C          | 65%                     |
| Self-discharge (25°C)                     | 3 month        | Remaining Capacity: 91% |
|   | 6 month        | Remaining Capacity: 82% |
|   | 12 month       | Remaining Capacity: 64% |
| Nominal operating temperature             | 25°C±3°C       |                         |
| Operating temperature range               | -15°C to 50°C  |                         |
| Float charging voltage (25°C)             | 2.25 to 2.30V  |                         |
| Cyclic charging voltage (25°C)            | 2.35 to 2.40V  |                         |
| Internal Resistance (Fully charged, 25°C) | Approx. 0.2 mΩ |                         |

**DIMENSIONS**

Outer dimensions (mm)

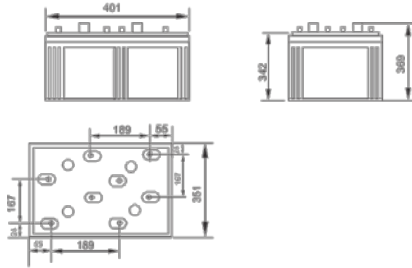

Terminal Type (mm)

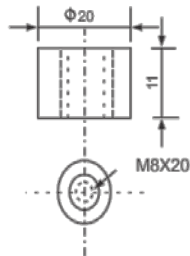

**DISCHARGE CHARACTERISTICS (25°C)**

Discharge Voltage (V/Cell)

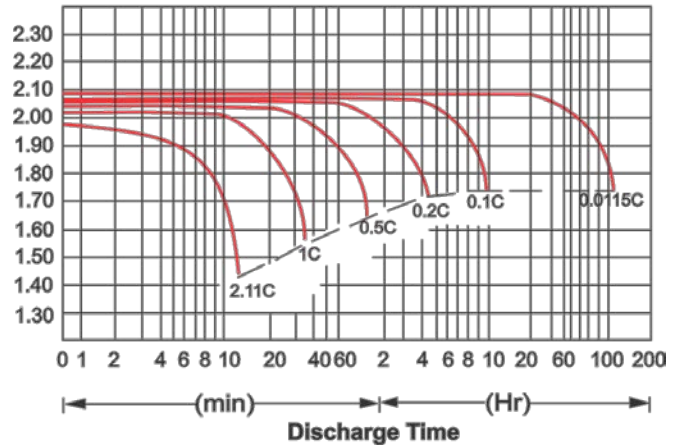

**CHARGING CHARACTERISTICS (25°C)**

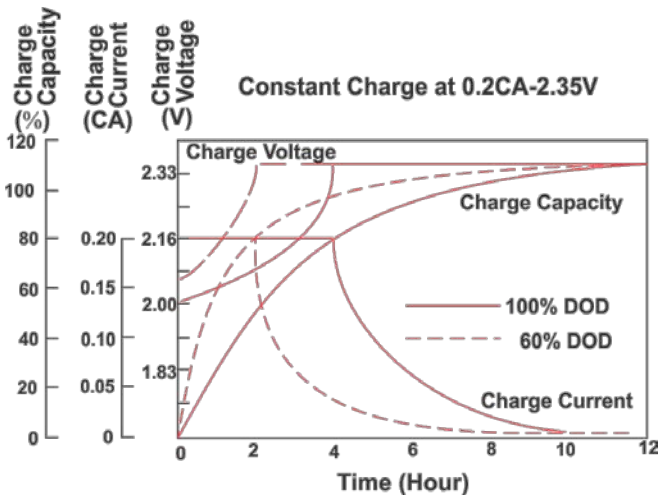

**CYCLE LIFE (25°C)**

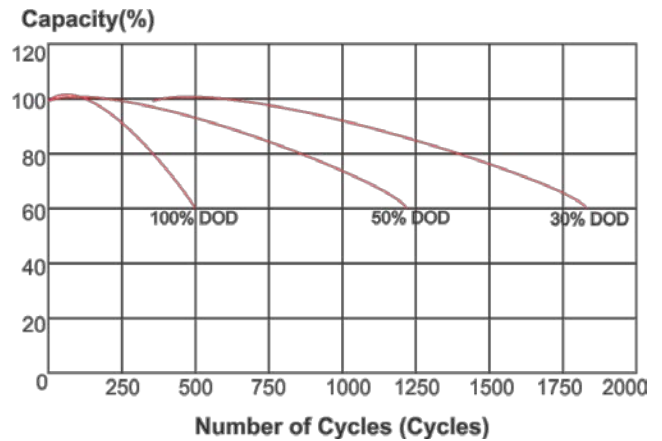

Specifications included in this datasheet are subject to change without notice. Electric data without guarantee.

Contact India Office:

Victory Mansion, Sitaladevi Temple Road, Mahim, Mumbai – 400016  
Ph: 022-6464-9090

Contact US Office:

509 Granger Terrace, Sunnyvale, CA – 94087  
Ph: +1-408-431-0408

